

MAPX	MODIFICATION	DATE
------	--------------	------

电气特性:Electrical:

- 1. 额定电流: Current Rating  
1.5A/contact terminal
- 2. 额定电压: Voltage Rating  
30V DC

- 3. 接触阻抗: Contact Resistance  
30 milliohms MAX

- 4. 耐电压: Dielectric Withstanding Voitage:  
500 V AC AT Sea Level

- 5. 绝缘阻抗: Insulation Resistance:  
100OMEGA ohms MIN

物理性能:Mechanical:

- 1. 插拔力: Connector Mate and Umate Force  
Mate force:3.57Kgf (MAX)  
Umate force:0.7kgf (MIN)

- 2. 端子保持力: Terminal Retention  
1.2kgf (MIN)

- 3. 寿命: 15000次

原材料:Material:

- 1. 塑胶:Housing:LCP黑胶

- 2. 端子:Contact:Copper Alloy C2680

- 3. 外壳:Shell:SPCC

电镀:Finish:

- 1. 端子Contact: Au 0.7u" Plated on contact area  
Tin50u" Plated on solder area

- 2. 外壳Shell: Nickel 50u" Plated underplating over all.

- 3. 外壳Shell: Nickel 50u" Min plating over all.

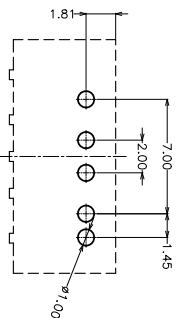
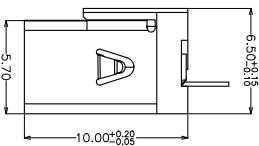
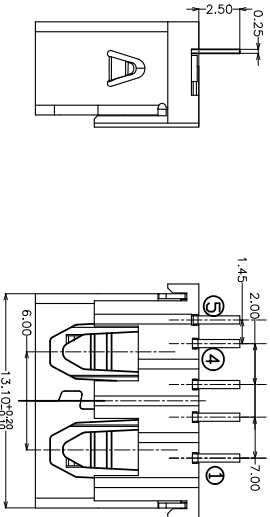
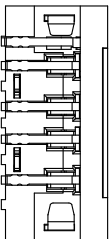
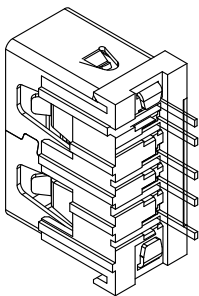

RECOMMAND P.C.B LAYOUT  
TOLERANCE: ±0.10

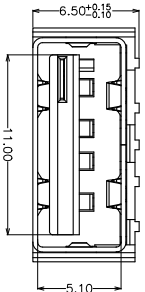

# 深圳市精拓金电子有限公司

Pin NUMBER	SIGNAL NAME
1	VBUS
2	D-
3	D+
4	GND
5	GND

产品图		公差一览表	
TOLERANCE UNLESS OTHERWISE			
X	±0.30	X	±5.°
X	±0.25	X	±2.°
.XX	±0.15	.XX	±1.°
.XXX	±0.10	.XXX	±0.5°

单位	UNIT	MM	制图	林属升	制图料号	916-451A2026V110200
比例 <td>SCALE</td> <td>1:1</td> <td>审核</td> <td>郭志富</td> <td>产品名称</td> <td>AP10_08W897N/800E宝珊连接器壳体零件图第6版</td>	SCALE	1:1	审核	郭志富	产品名称	AP10_08W897N/800E宝珊连接器壳体零件图第6版
日期 <td>DATE</td> <td>2019.11.23</td> <td>核准</td> <td>黄国荣</td> <td>角法</td> <td>第一角法</td>	DATE	2019.11.23	核准	黄国荣	角法	第一角法
			APPD		版本	A0